

NOTE: ALL RADII 20'  
L = 31.42

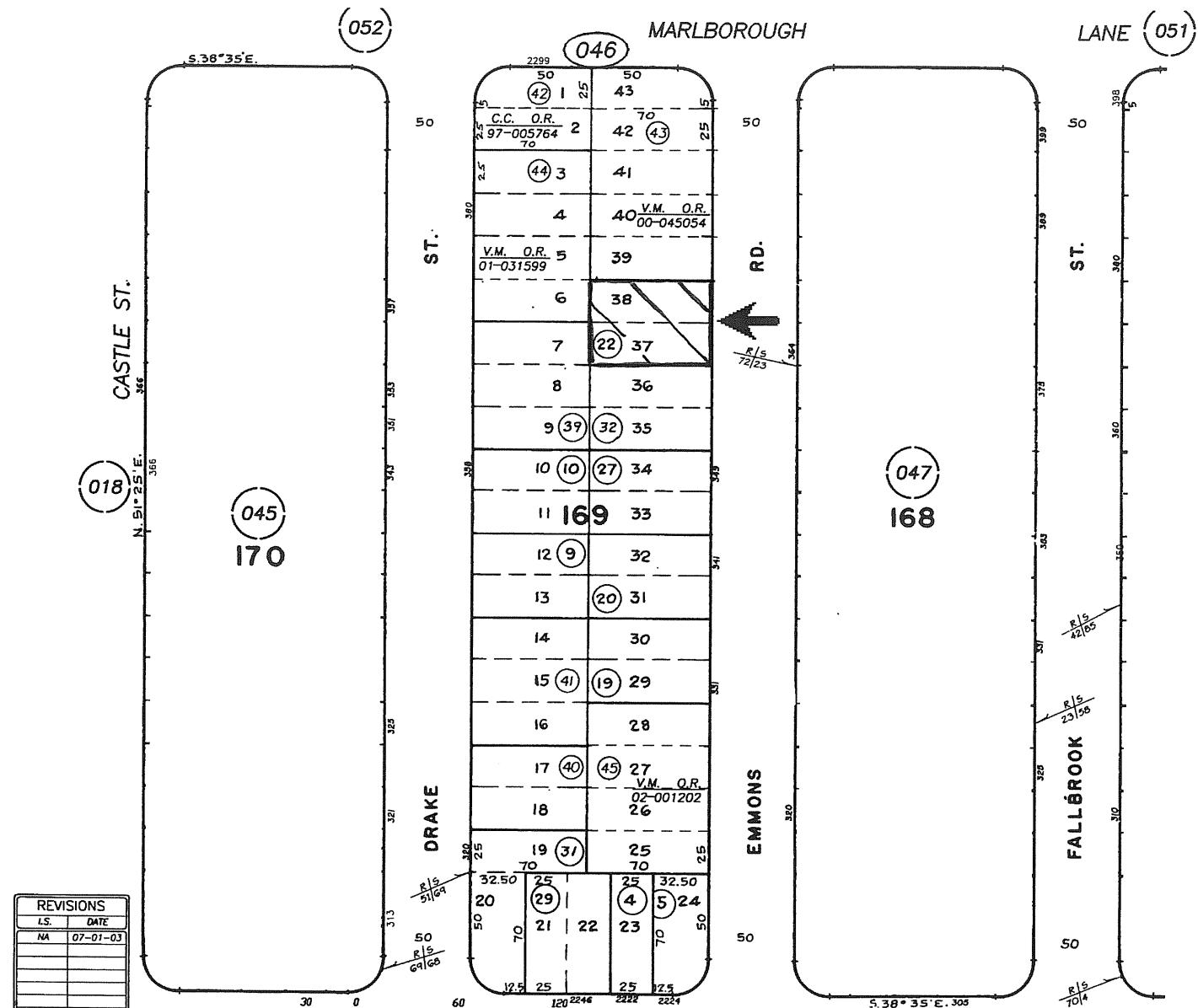

REVISIONS	
LS	DATE
NA	07-01-03

02-28-98 GB THIS MAP IS PREPARED FOR ASSESSMENT PURPOSES ONLY.

018

045  
170

046

047  
168

042

043

MARLBOROUGH

LANE 051

WINDSOR BLVD.

CAMBRIA PINES MANOR UNIT NO. 7, R.M. Bk. 05, Pg. 16

AUG 06 2003  
CAMBRIA  
ASSESSOR'S MAP, COUNTY OF  
SAN LUIS OBISPO, CA.  
BOOK 023 PAGE 046